

RELO

SUBSTRUCTURE

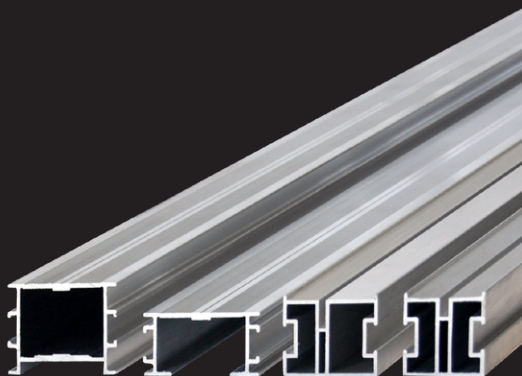

RELO W reversible joist can be installed on both sides, either with a flat surface or with the ventilation channel on top depending on the fixing system used. The unique combination of structural design and overall dimensions ensures extremely high stability and load bearing capacity.

RELO C is a compact design suitable for low construction heights. Despite its low construction height, the overall design provides the decking with high structural stability.

RELO T is a system substructure joist for the TENI clips. The integrated screw channel enables angled screw installation into aluminium. Two lateral guides automatically align and centres the clip on the substructure joist.

RELO N is a system substructure joist for LIGO and PLATA. The integrated screw channel facilitates easy screw fastening in aluminum. In addition, the 9 mm recessed screw channel significantly reduces shear forces acting on the fastenings. Two lateral guides automatically align and center the decking clips on the substructure joist, which is completely concealed by the clips.

OVERVIEW	RELO W	RELO C	RELO T	RELO N
KONEKTO	■		■	■
SUPRO	■		■	
ZONA	■		■	
DILA	■		■	
LIGO	■/-		■/-	■
PLATA	■/-	■/-	■/-	■
TENI			■	
PROFILA2	■/-	■	■/-	
SOLIDA4	■/-	■	■/-	
CERAMIC	■		■	

Legend:

- suitable
- /- partially suitable (reduced ventilation and/or increased shear forces)

Material:

Aluminium AN AW 6060 T66
optional with powder coated black finish RAL9005

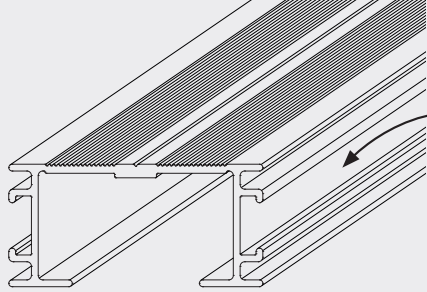

RELO C compact design for low construction heights

Identical mounting guides for the RELO system accessories

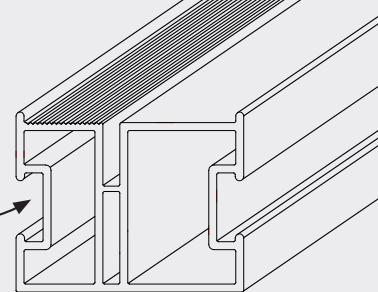

RELO T with angled screwing channel for TENI decking connectors

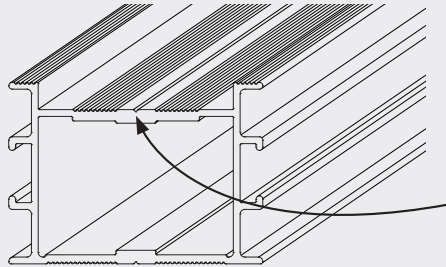

RELO W reversible joist with integrated ventilation channel

The 3.0 mm thick mounting plate ensures secure and permanent fixation of the fixtures.
The ribbed surface with recessed center V-groove indicates the best screw positioning and facilitates screw installation.

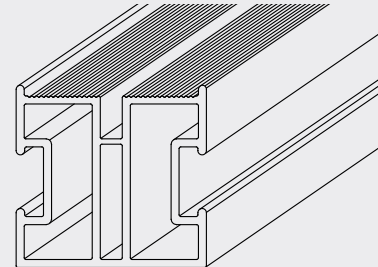
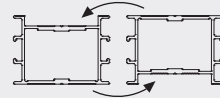

RELO N with integrated screw channel for LIGO and PLATA decking connectors

The 6.0 mm high ventilation channel provides structural protection for the decking with visible screw connections using PROFILA2 while reducing shear effects on the fixings by 30%.

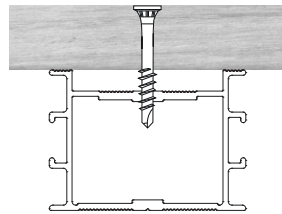

DOWNLOADS



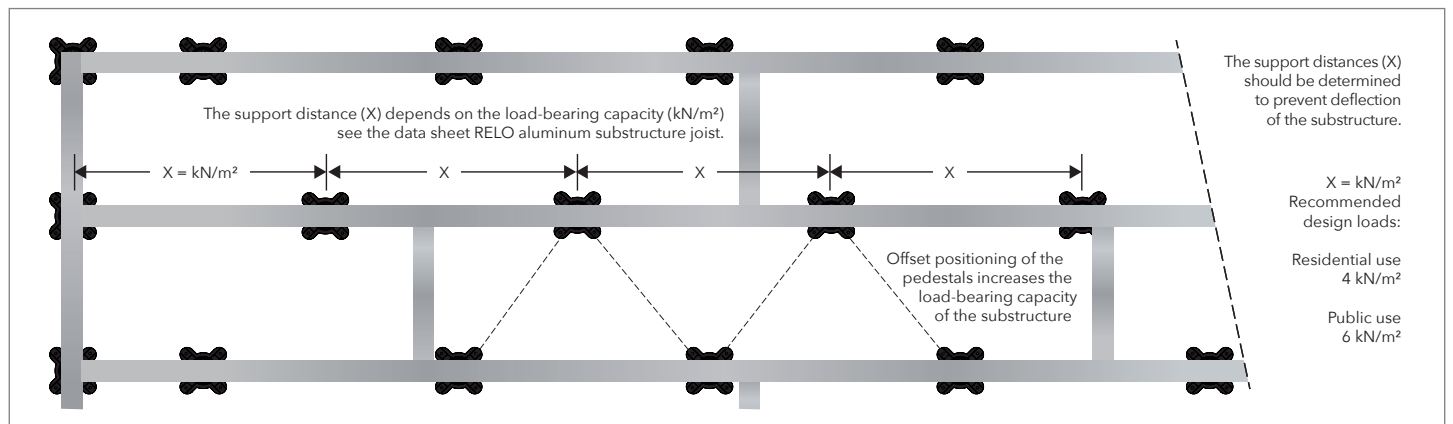

Data Sheet Tips & Tricks

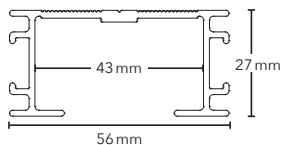

RECOMMENDATION

Frame construction: cross bracing every 2.0 meters - offsetting cross bracing increases stability.
Counter-battening construction: Screw a counter-batten every 2.0 meters with PROFILA profile self-tapping screws.



RELO C 56 x 27 mm		
PU	Description	Product No.
99 PCS	L 2.000 mm bright	033700000
99 PCS	L 4.000 mm bright	033700001
99 PCS	L 4.000 mm black	033700002

RELO W 56 x 40 mm		
PU	Description	Product No.
99 PCS	L 2.000 mm bright	033800000
99 PCS	L 4.000 mm bright	033800001
99 PCS	L 4.000 mm black	033800002

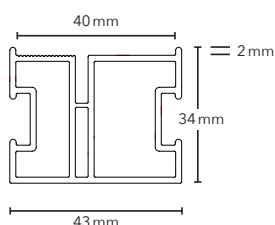
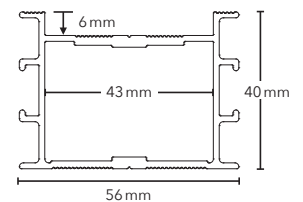

RELO T 43 x 34 mm		
PU	Description	Product No.
144 PCS	L 2.000 mm bright	016500001
144 PCS	L 4.000 mm bright	016500000

RELO N 36 x 34 mm		
PU	Description	Product No.
144 PCS	L 2.000 mm bright	016600000
144 PCS	L 4.000 mm bright	016600001

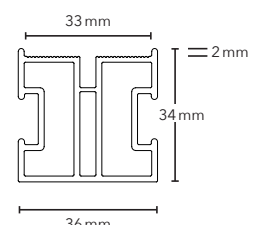

RELO

SYSTEM ACCESSORIES

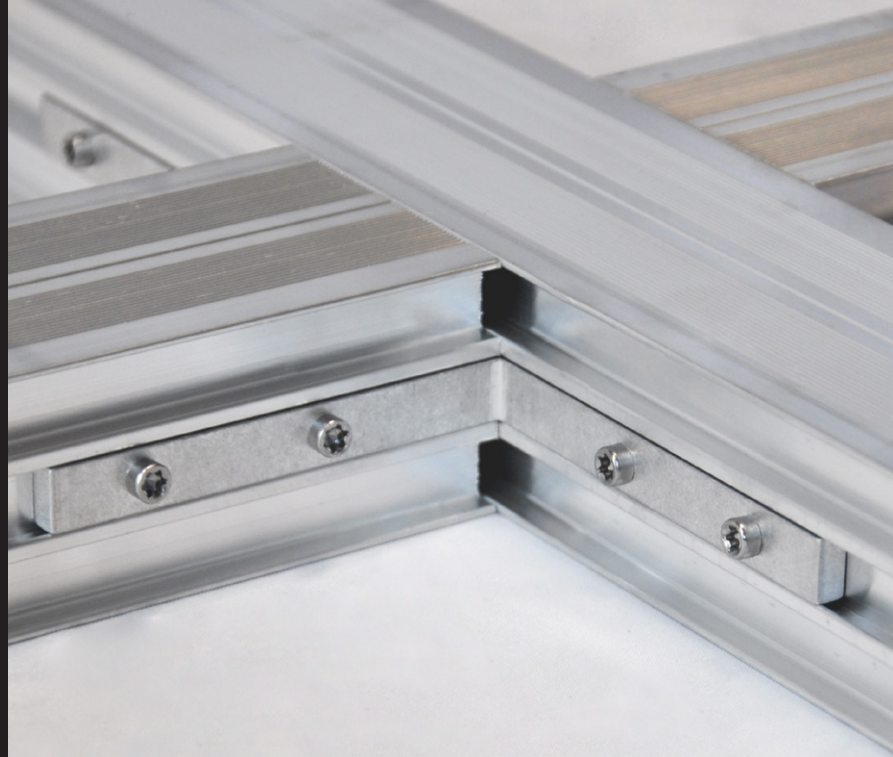
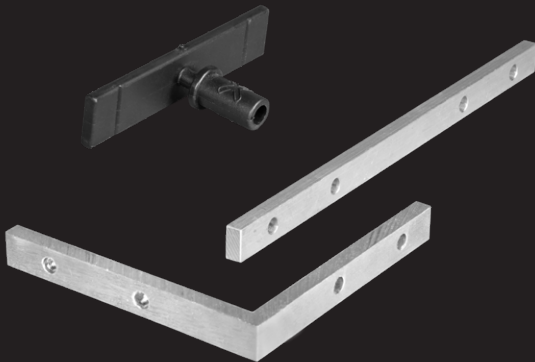

The RELO system accessories enable a simple and rapid assembly of terrace substructures.

RELO E corner bracket enables securely fastened corner connections, e.g. for cross bracing in frame constructions.

At each connection point, the corner brackets are securely fastened on both sides of the substructure.

RELO L extension brackets permit continuous aligned length extensions of substructure joists. The length joist connections should be positioned directly over loadbearing points i.e. pedestals.

The extension brackets are mounted on both sides of the substructure.

RELO A adapter facilitates screwless installation of LIFTO adjustable pedestals on the substructure joist.

OVERVIEW	RELO E	RELO L	RELO A
Dimensions:	80 x 80 x 10 x 5 mm	160 x 10 x 5 mm	60 x 12 mm
Material:	Aluminium blank	Aluminium blank	PP Polypropylen recycled

DOWNLOADS



Data Sheet



Tips & Tricks

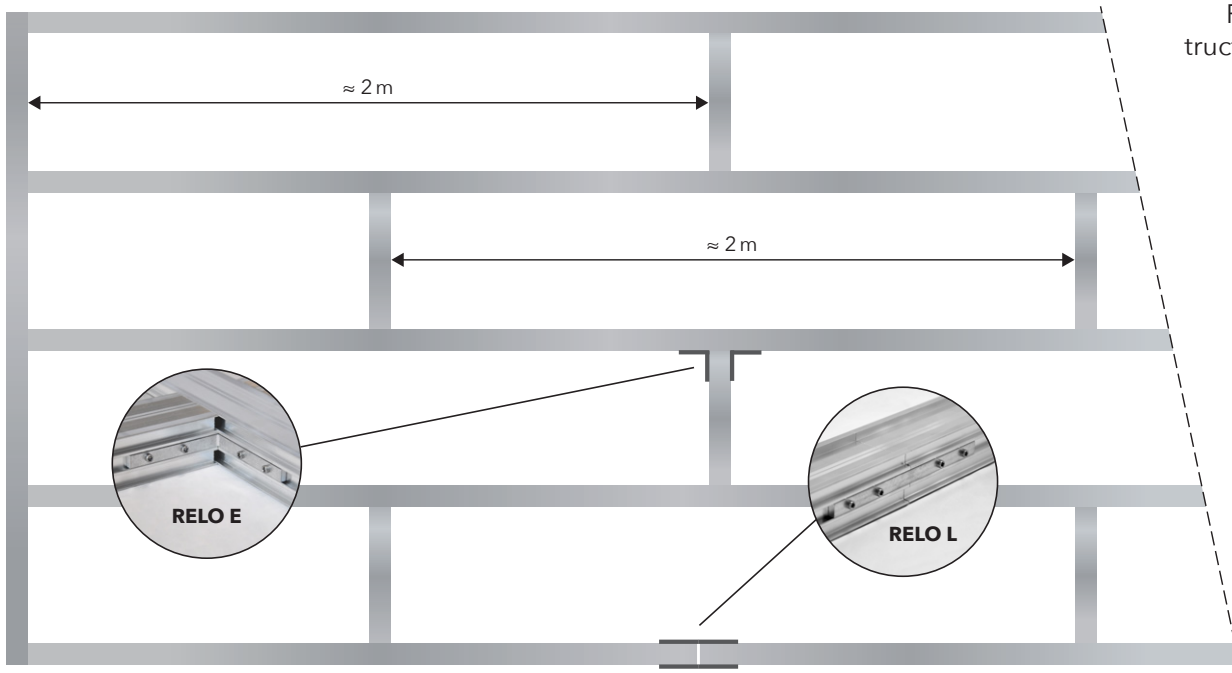
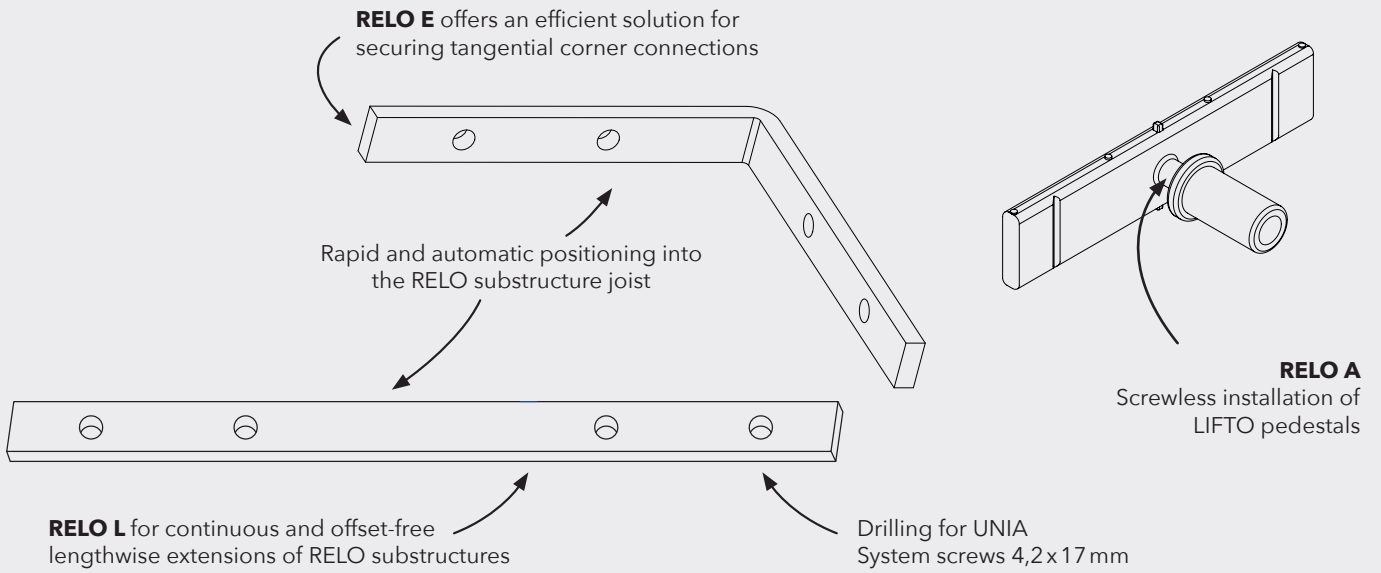

RELO frame construction with securely fastened corner and lengthwise connections.

This design significantly simplifies the installation and alignment of the substructure.

RELO E corner bracket SET	
PU	Product No.
25 PCS	014603000
50 PCS	014603001

RELO L extension bracket SET	
PU	Product No.
25 PCS	014703000
50 PCS	014704001

RELO A adapter	
PU	Product No.
40 PCS	009603000



SET-PACK
Each package contains all the UNIA system screws required for mounting.



BRANDING
If desired, your LOGO can be printed on the elegant product packaging.

